

48" x 96" Slatwall Panel Installation Instructions

Each of our slatwall panels come with an installation label on the back side that will help you determine the best "factory edge."

Stock cut panels
48" x 96"

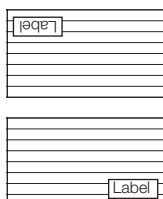

Vertical cut panels
96" x 48"

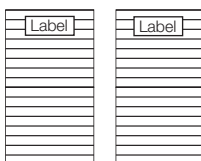

For best groove alignment, install panels with labels as shown in the diagram to the left.

1. Install over studs, plaster or drywall. When installing over drywall, use a stud finder to mark the center of each stud on the pre-drawn level line.
2. Spreading panel adhesive on the back of panel is optional. One panel generally uses a half-tube of adhesive.
3. Use the correct length screw to attach panel to the wall, screwing through every other groove on each stud (see Illustration A below). Installing panels with metal inserts works basically the same as those with raw grooves. If using a standard screw (not self-tapping), it is recommended to pre-drill the metal using an 1/8" drill bit.

Due to the uniqueness of each installation, **fastening screws are not included.**

Illustration A →

Install dry wall screws through the back of the grooves.

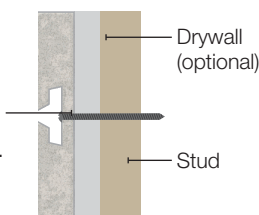

4. If cutting is required, cut panels with a circular saw. The saw blade should enter the finished side of the panels (back side of board facing up). If panels have aluminum inserts, leave them in the grooves and then use a jig saw with a fine tooth metal blade to cut through the metal.
5. Repeat the process for the remaining panels making sure you line up the grooves from panel to panel.

For more information, call 800.548.7528 to speak with one of our expert Project Managers or visit www.windmillslatwall.com or www.garageescape.com.

Environmentally Friendly

- CARB 93120.2 compliant
- USGBC/LEED eligible product

Necessary Tools

- Safety glasses
- Level
- Tape measure
- Pencil
- Stud finder
- 1 1/2" to 2" drywall or other equivalent screws (use round panhead screw for metal inserts)
- Drill (screw gun)
- Circular saw for cutting

Safety First

Use all tools according to the manufacturer's recommendations.

Dos and Do Nots

- DO distribute weight equally on the panels.
- DO use tools per manufacturer's recommendations.
- DO NOT climb, hang, or step on the accessories.
- DO NOT overload accessories with additional weight.
- DO NOT drop heavy items on accessories.